

256569 TP100 Kit and 256570 Stud Wall Foam Kit

313121D

For use with Fusion™ CS Spray Guns. To spray wall insulation foam into stud walls with a single pass.

**Important Safety Instructions**

Read all warnings and instructions in this manual and in 312666. Save these instructions.

256569 TP100 Kit

Ref. Part	Description	Qty.
1 256978	HOUSING, tip	1
2 296348	TIP, TP100	1
3 256650	SEAL, tip, TP100	1
4 256977	RING, retaining, tip	1

256570 Stud Wall Foam Kit

Ref. Part	Description	Qty.
1 256978	HOUSING, tip	1
2 15C440	TIP, FTM979, flat	1
3 256651	SEAL, tip, FTM979	1
4 256977	RING, retaining, tip	1

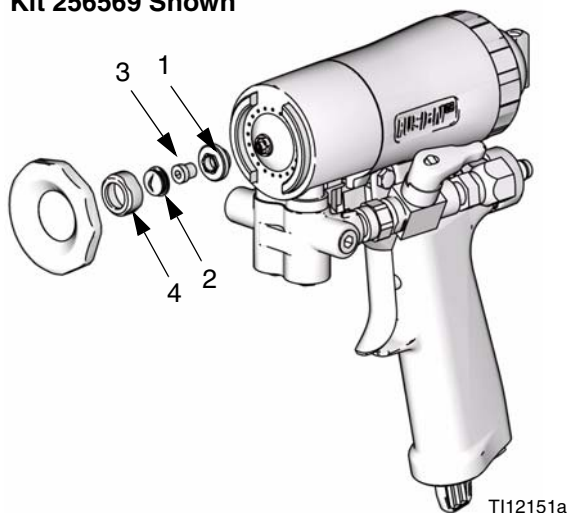
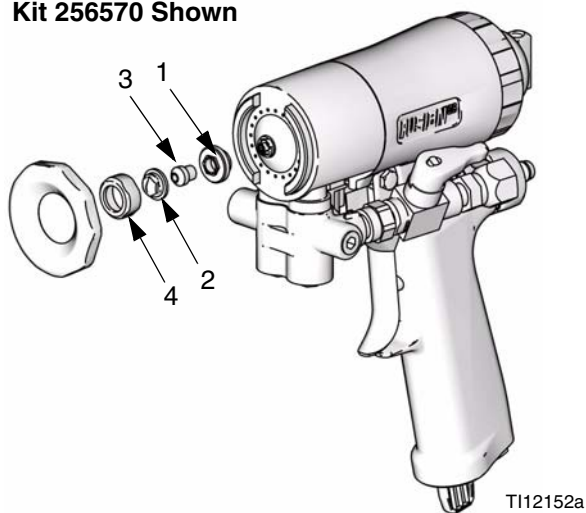
Kit 256569 Shown**Kit 256570 Shown**

Installation

 This kit will not work with round mix chambers (i.e. RDXXXX). If there is a round mix chamber in the gun, replace it with a flat mix chamber. Smaller flat mix chambers can be ordered for lower fluid flow applications. See Flat Mix Chamber Kit chart below.

Flat Mix Chamber Kit*	Type	Flow Rate (approx.) at 1000 psi (7.0 MPa, 70 bar)
FL0202	Standard	15 lb/min (6.81 kg/min)
FL0101	Standard	11 lb/min (4.99 kg/min)
FL0000	Standard	7 lb/min (3.18 kg/min)
FL2020	Standard	3 lb/min (1.36 kg/min)

* Includes mix chamber and cleanout tool.

 An FTM979 Stud Wall Tip is included in this kit. An FTM762 Stud Wall Tip is available for lower fluid flow applications as an accessory.

	FTM979 Stud Wall Tip	FTM762 Stud Wall Tip
Pattern size	22 in. (559 mm)	14 in. (355.6 mm)
Spray distance	2 ft. (0.61 m)	2 ft. (0.61 m)
Fluid flow‡	15 lb/min (6.81 kg/min)	13 lb/min (5.90 kg/min)

‡ When used with mix chamber FL0202 at 1000 psi (7.0 MPa, 70 bar).

 The small plastic o-ring on the end of the flat mix chamber must be removed.

1. Remove the front cover retainer from the Fusion CS gun. Thread the adapter (1) onto the mix chamber until it bottoms out.
2. Insert the packing (3) through the center of the adapter (1) with the stepped end facing the mix chamber.

3. Place the stud wall tip (2) onto the packing (3) and tighten the retaining ring (4) with light hand force.

 Overtightening may distort the packing inside the mix chamber. Reopen the hole with the 0.94 in. (3/32 in., 2.39 mm) drill bit provided if necessary.

4. Adjust the FTM979 tip orientation with a standard 5/16 in. nut driver (provided with gun). See FIG. 1.

 TP100 tip only: adjust tip orientation prior to tightening retaining ring (4).

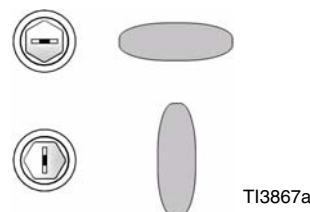

FIG. 1

Cleaning Tips

 Instructions apply to stud wall tip only.

1. If the pattern begins to shrink or becomes distorted, relieve pressure (see your gun manual) and clean the internal dome of the tip (2) with the tip cleanout tool (15D234). See FIG. 2.
2. Clean out the inside diameter of the packing (3) and the flat mix chamber with a 0.94 in. (3/32 in., 2.39 mm) dia. drill bit (Graco cleanout tool kit 246624).
3. Add a thin layer of lubricant on the outside faces of the air cap (3) to ease cleaning.



FIG. 2



WWW.DIAMONDLINERS.COM

Mailing Address

9507 Santa Fe Springs Road
Santa Fe Springs, CA 90670

Phone

(562) 781-1045 or (800) 543-1212

Fax

(562) 781-1045

Email

info@diamondliners.com

Graco Headquarters: Minneapolis
International Offices: Belgium, China, Japan, Korea

GRACO INC. P.O. BOX 1441 MINNEAPOLIS, MN 55440-1441

Copyright 2008, Graco Inc. is registered to ISO 9001

www.graco.com

Revised 04/2009